

# Transformers 1-phase



Type series MT20 with approx. 300 to 1500VA; special transformers vertical.  
 This type series with enlarged winding space is suitable for high-voltage or high-current transformers as well as high insulation voltages.

**BREMER 1440-en**

Design:	Vertical	Ambient temperature:	ta = 40°C (ta = 40/B)
Type series:	"EI-low-waste" type	Temperature rise:	ΔT = ca. 45...50K (40/B)
Terminals:	According to customer requirements	Core material:	Standard material

Core-Type	Power approx. VA	Weights copper / total kg	Dimensions with terminals				Mounting dimensions	
			Width B mm	Depth T mm	Height H mm	Height HK mm	C x D mm	For screw
MT12 EI130a/37,7	300	1,8 / 5	105	105	145	220 (UK4/6)	90(65) x 70	M 8
MT13 EI130b/47,7	350	2,1 / 6	105	115	145	220 (UK4/6)	90(65) x 80	M 8
MT14 EI150a/41,7	400	3,0 / 7	120	122	165	240 (UK10)	105(75) x 82	M 8
MT15 EI150b/51,7	450	3,4 / 8	120	132	165	240 (UK10)	105(75) x 92	M 8
MT16 EI150c/61,7	500	3,7 / 9	120	142	165	240 (UK10)	105(75) x 102	M 8
MT17 EI170a/56,7	750	5,0 / 12	140	151	190	270 (UK10)	120(85) x 110	M 10
MT18 EI170b/66,7	850	6,0 / 14	140	161	190	270 (UK10)	120(85) x 120	M 10
MT19 EI170c/76,7	950	7,0 / 16	140	171	190	270 (UK10)	120(85) x 130	M 10
MT20 EI195a/57,7	1100	8,0 / 21	180	162	210	285 (UK10)	155(95) x 105	M 10
MT21 EI195b/70,7	1300	9,0 / 22	180	175	210	285 (UK10)	155(95) x 118	M 10
MT22 EI195c/85,7	1500	10,0 / 24	180	190	210	285 (UK10)	155(95) x 133	M 10

The transformers of this core type series are characterised by a large winding space.

They are therefore particularly suitable for special applications in which either - compared to standard mains transformers - a particularly large space is required for insulating materials extreme copper cross-sections are mounted.

We use these cores to manufacture customised high-current transformers, e.g. so-called glow strip transformers for plastics processing machines. These types are also well suited for high-voltage and insulating transformers in the two-digit kV range, e.g. for plasma processes.

The above-mentioned power specifications are for orientation as a comparison with a mains transformer. We would be pleased to design customised, individual transformer for your requirements in the field of high voltage technology or for high currents.

Insulation class B / highest final temperature according to IEC60085: B = 130°C

More about temperatures, standards, no-load / load behaviour, insulating materials and insulating material classes under Technical Terms

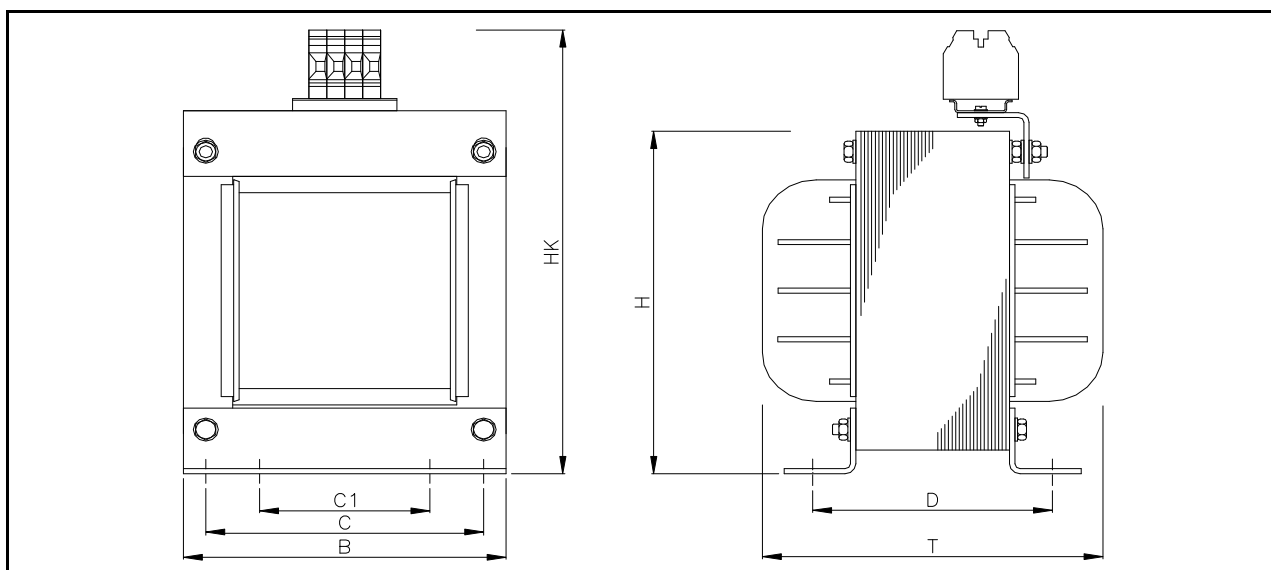

Error and subject to change

© BREMER Transformatoren GmbH

Status: 07.10.2021 11:20

Table: BREMER 1440-en-dt\_1MT-SS-MAW-UKK\_d.xls

Sketch: 1MT-SS-MAW-UKK-L-aax-RF050512.dwg

We develop and produce only in Germany / Berlin-Ludwigsfelde

**BREMER Transformatoren GmbH**

Feel free to call us: Phone +49 (0)3378 20 06-0

www.bremer-trafo.de info@bremer-trafo.de